

HSE ROHS

REV	ECN NO	DESCRIPTION	DATE	NAME
A		NEW		

MATERIALS:

Contact : Brass
 Housing: PBT, UL 94V-0 blue
 Shell : Cold Roller Steel
 Board lock: Brass
 SCREW:free-cutting Steel
 FINISHES:
 Contact Finish: GOLD PLATING ON CONTACT AREA.
 TIN PLATING ON SOLDERTAILS.NICKEL UNDER PLATING OVER ALL.
 Shell Finish: NICKEL PLATING OVER ALL.
 Board lock Finish: TIN PLATING OVER ALL.
 NICKEL UNDER PLATING OVER ALL.

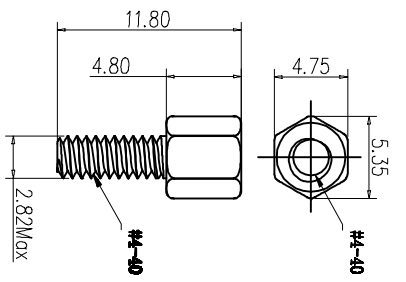
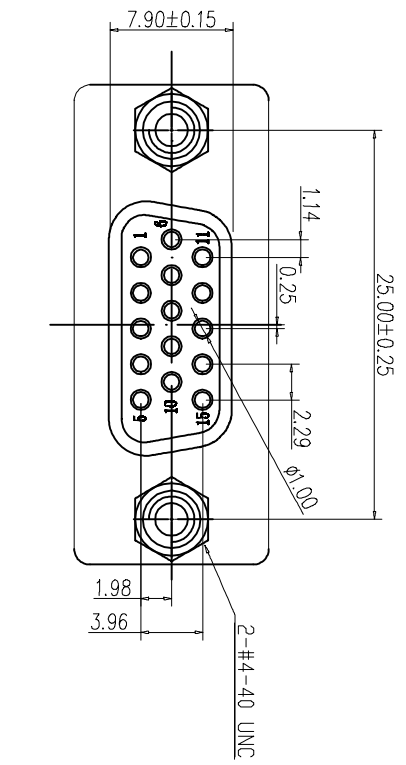

Screw specification

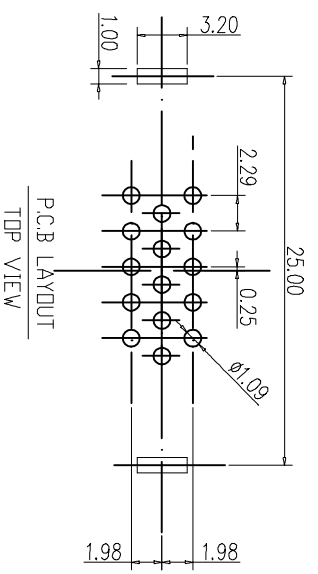
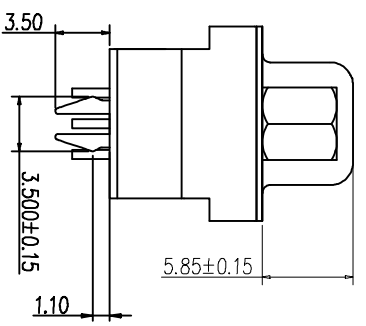
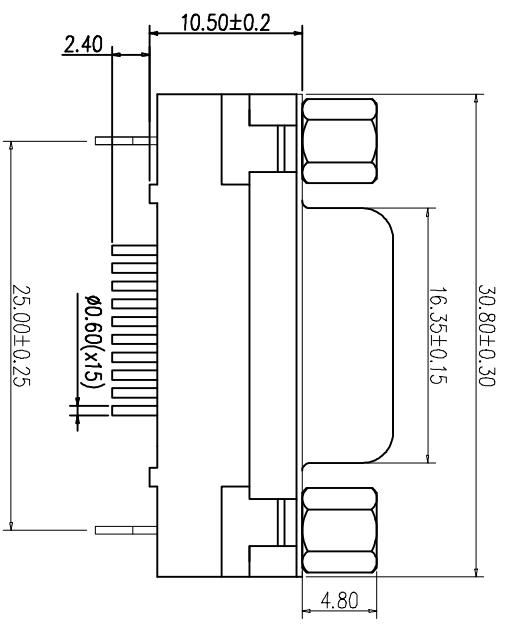

P.C.B LAYOUT
TOP VIEW

Ordering Information
L880X X - X X XX X

- 0: 180°
- 1: 90°
- 2: SMT
- 9: Welding line
- 0: 0.8U°
- 1: 1U°
- 4: 3U°
- 5: 5U°
- 6: Au/Sn
- 7: Au/Sn
- 8: Ni
- 1: Riveted screw
- 2: Locking screw
- 3: Without screw
- 4: No screw holes
- 1: Black
- 2: White
- 3: Blue
- 8: Attrorixems
- Serial number 01-99
- Peeling
- Au-Sn
- Bridges
- Cutting
- Panel

STANDARD TOLERANCE (EXCEPT SPECIFIED)	LINER	ANGLES
.0 ±0.30	0.°	±3°
.00 ±0.25	.0°	±2°
.000 ±0.15	.00°	±1°

LDCONN 东莞连大精密制品有限公司		Dongguan Lianda Precision Products Co., LTD	
TITLE	D-sub-X 15P Female 180° With harpoon Straight locks H10.5	DRAWN BY	LuJunhui
PART NO	L88002-XXXX	CHECKED BY	
DRAWING NO		APPROVED BY	
SCALE	1:1	UNIT	mm
		PAGE	1/1
		SIZE	A4